

Proposed Site Plan

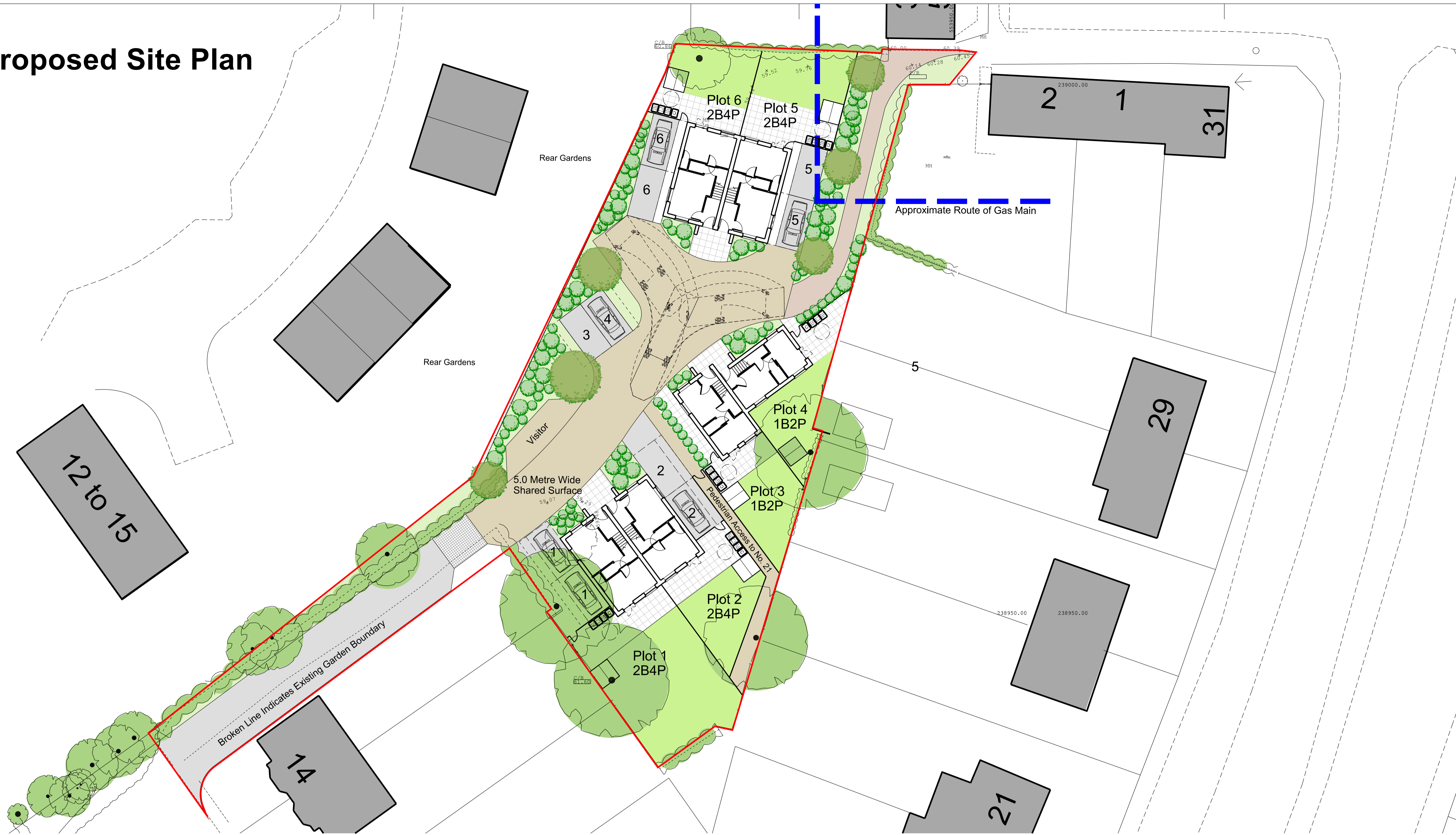

- Notes:**
- All dimensions to be verified on site by GENERAL CONTRACTOR and any discrepancies to be brought to the attention of the Architect prior to commencing work or setting out or preparing shop drawings.
 - Drawings not to be scaled. Work to figured dimensions only.
 - © copyright SAUNDERS BOSTON LIMITED. All rights reserved. This drawing remains the property of SAUNDERS BOSTON LIMITED at all times and may not be reproduced or copied in whole or in part without their prior written consent.
 - This drawing and related specifications are for use only in the stated location.
 - This drawing is to be read in conjunction with all other Consultants drawings and specifications.
 - Drainage has not been surveyed and all pipe locations and and below ground drainage runs are indicative

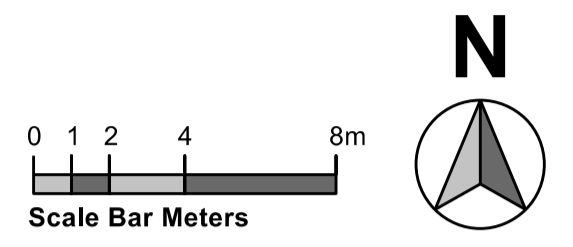

2B4P Elevation
Plots 1 & 2 + Plots 5 & 6



1B4P Elevation
Plots 3 & 4

Schedule
 4No. 2B4P Houses with 2 No. Parking Spaces
 2No. 1B2P Houses With 1 No. Parking Spaces
Site Total: 6 No. Houses
Total Site Area: 0.19 Hectares

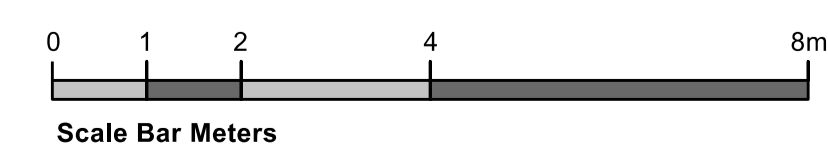

PRELIM FOR COMMENT

No.	Revision	Date	Chk	Auth
A	Number 21 Access Shown, General Revisions	30/3/2014	NDMG	NDMG

FOR DISCUSSION

Chartered Architects
 119 Newmarket Road
 Cambridge
 CB5 9BA
 Tel: (01223) 367733
 E-mail: office@saundersboston.co.uk

Saunders Boston

Client: **Uttlesford District Council**

Job: **Catons Lane Saffron Walden**

Drawing: **Proposed Site Plan**

Scales	Date
1:200 @ A1, 1:400 @ A3 1:100 @ A1, 1:200 @ A3	March 2014
Number	Authorised
1343-SK-001	LG NDMG